



DOOR CANOPIES FITTING INSTRUCTIONS MATLOCK PITCHED

PRO-CAN

DOOR CANOPIES

Your ProCan door canopy kit contains:

ITEM	QTY
Canopy	1
Gallow Brackets	2
Fixing Kit	1

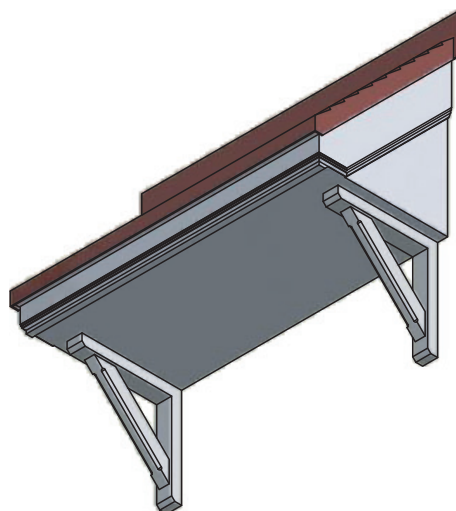

INSTALLATION

1. Position the brackets equally either side of the door aperture. Brackets must be level with each other, vertical and set higher than the top of the door.
2. Drill the brackets to accept the screws (at least 2 per bracket - 10mm holes), then drill through the bracket holes straight into the wall using a 10mm masonry bit. Fully insert a 120mm wall plug fixing into each hole. Fully screw the gallows brackets to the wall while checking for horizontal and vertical alignment. Caps are provided to cover all fixings.
3. Centre the canopy on the brackets. Use a 10mm bit to drill through the GRP upstand into the wall at maximum of 450mm centres. Insert an 80mm wall plug into each hole and fully screw the upstand to the wall. The upstand must be over flashed in lead or sealed with mastic.
4. Predrill the brackets and fix each one upwards into the canopy soffit in two places on each bracket. Caps are provided to cover all fixings.

Note: The Gallows Brackets are NOT to be used as the main structural support for the canopy.

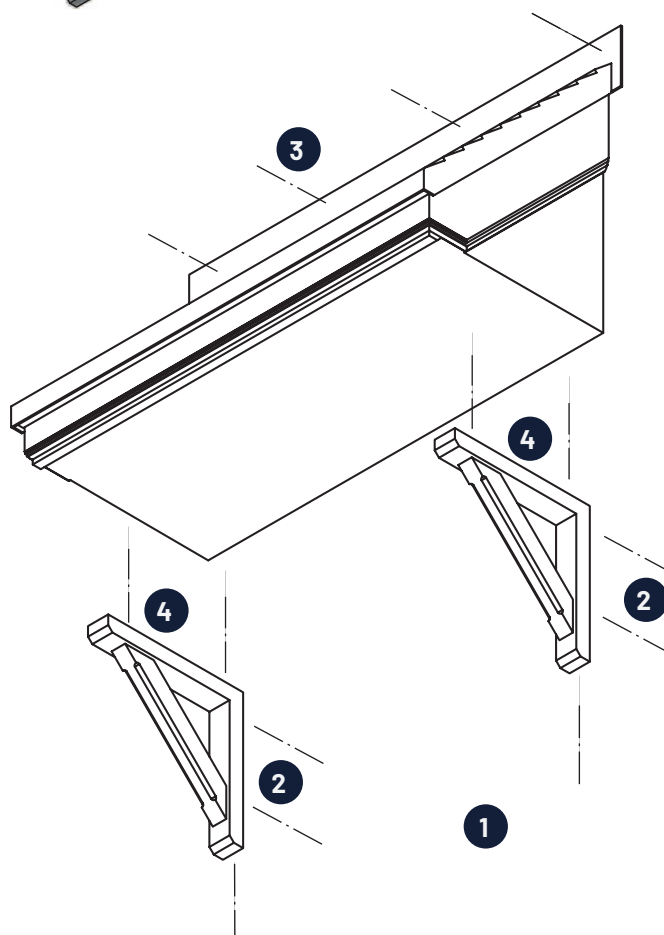

FLAT



ARCHED



MONO PITCH



APEX



DOOR CANOPIES FITTING INSTRUCTIONS MATLOCK PITCHED

PRO•CAN
DOOR CANOPIES

Handling

Mouldings can usually be carried manually. If mechanical handling equipment is used, always use suitable battens or bearers to protect the product. Remove the protective packaging only when fixing is imminent. Care should be taken not to damage the surface of the GRP.

Storage

Always store the canopy on its back i.e. with the fixing flange face downwards, covered and dry. If stored externally, do not expose to direct sunlight whilst inside the packaging.

Maintenance

GRP is low maintenance and will not require regular painting or decorating. To maintain its finish we advise cleaning periodically using an ammonia free detergent solution. Abrasive cleaners, wire wool or scourers should not be used as they may scratch the finished surface.



FLAT



ARCHED



MONO PITCH



APEX